

Techn. Data : Oriental 5

Log length (W x D): 470 x 320 cm

Wall size(outside): 450 x 300 cm - Log thickness: 40 mm

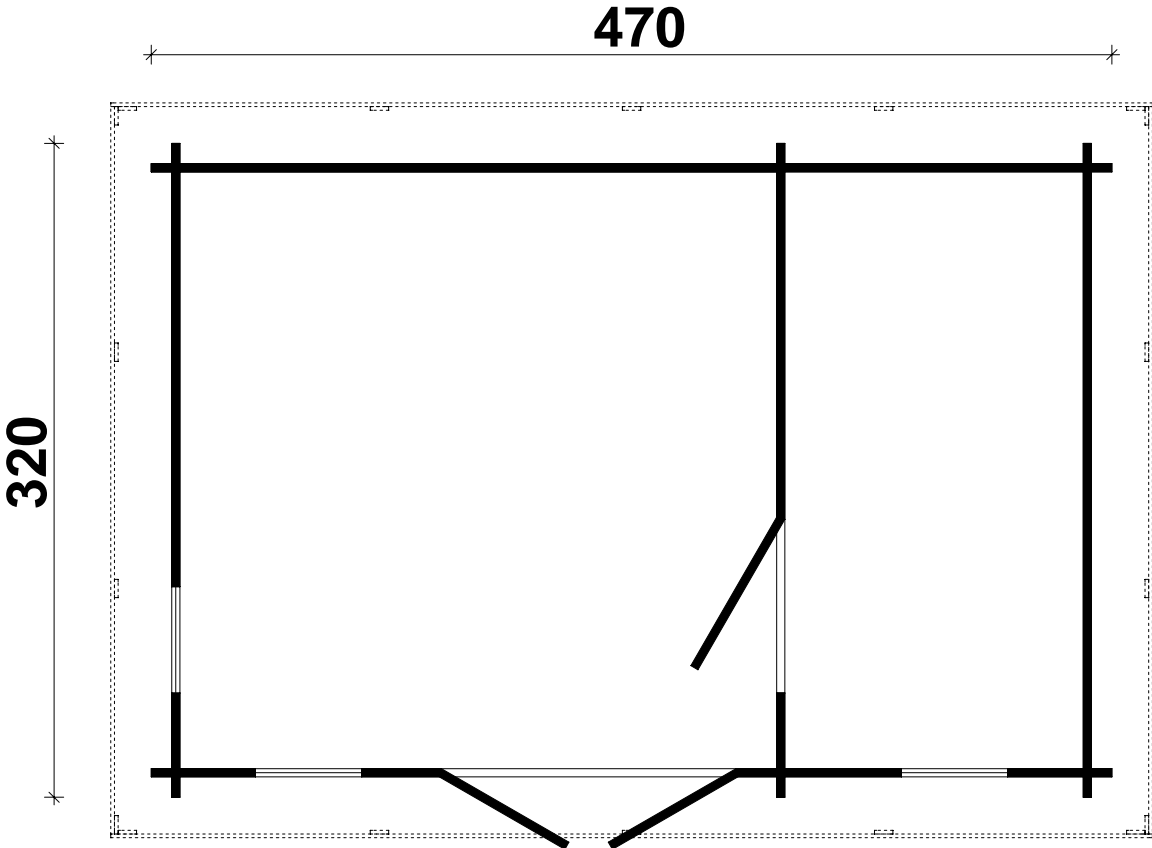

Note: All dimensions are approximate !

Oriental 5 / 40 mm - 470 x 320 cm

Nr.	Description	Profile mm	Length mm	Quantity pcs
001	Foundation		4490	7
002			417	3
003			4700	1
004			1420/1840	1/1
005			4700	18
006-1			3200	19
006-2			3200	1
006-3			3200	1
006-4			3200	1
007			510	66
008			810	17
009			390	17
010			2170	16
011			1840	16
012		3200	3	
013			5060	2
014			5060	3
015			5098	2
016			3560	2
017	Roofing felt			--
018	Roof board		3510	58+1/46+1
019	Floor board		2916	51+1/41+1
020	Baseboard		ca. 20,5 m	
021	Storm braces		2150/2010	2/2
022	Roof edge reinforcement		2530/3455	2/2
023		45x70	280	6
024		40x143	280	4
025	Screws 4,0 x 40 ; 4,0 x 50			35/700
026	Screws 5,0 x 70 ; 5,0 x 140			100/35
027	Nails 1,4 x 35			50
028	Bolt M 8 x 70, nut, washer			12
029	Hit block		300-400	2
030	Double door ca. 1425 x1955 mm - 40 mm / Standart +			1
031	Door ca. 840 x1835 mm - 40 mm			1
032	Window ca. 515 x1890 mm - 40 mm / Standart +			3

Oriental 5 / 40 mm - 470 x 320 cm

Ground plan

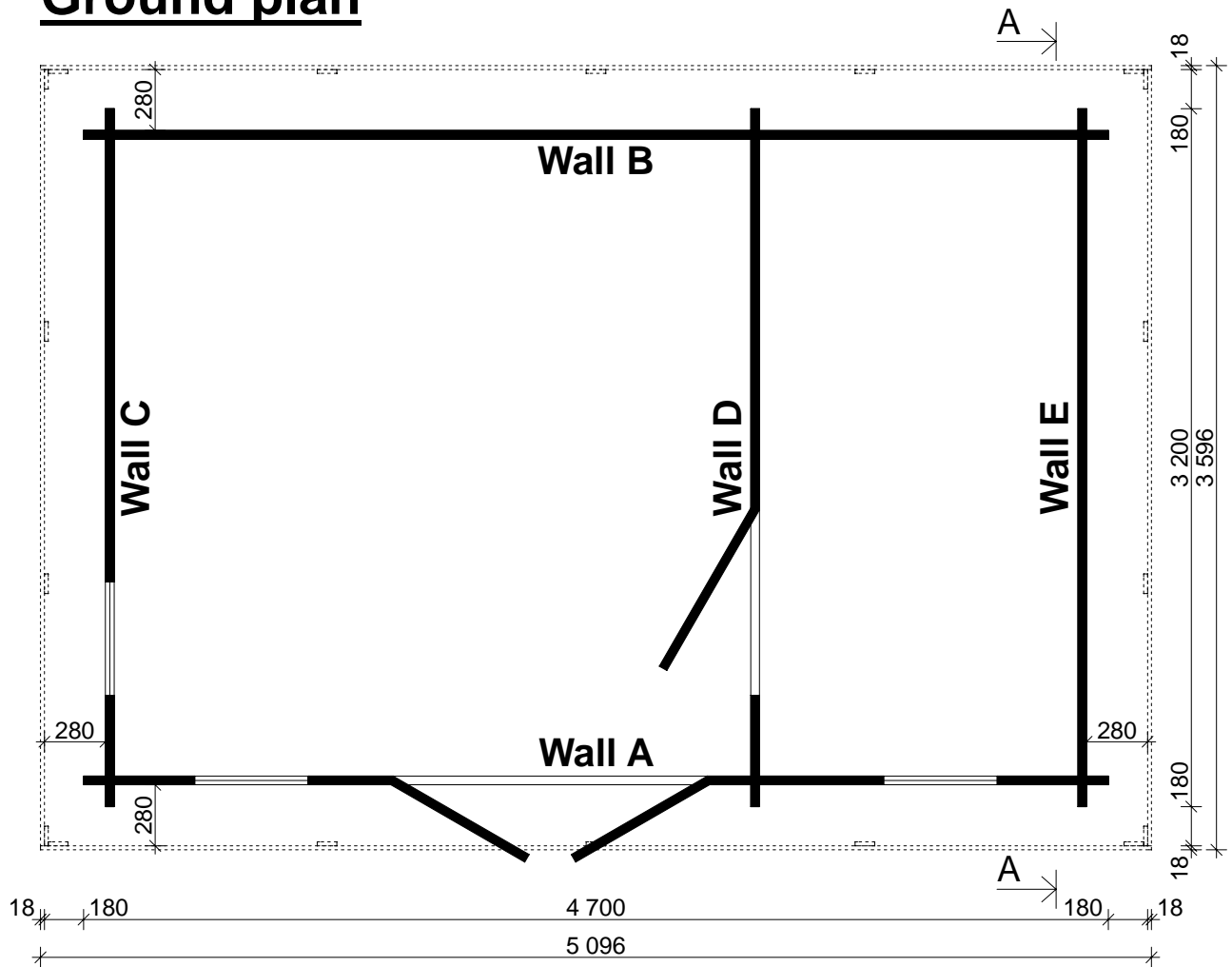

Foundation beams

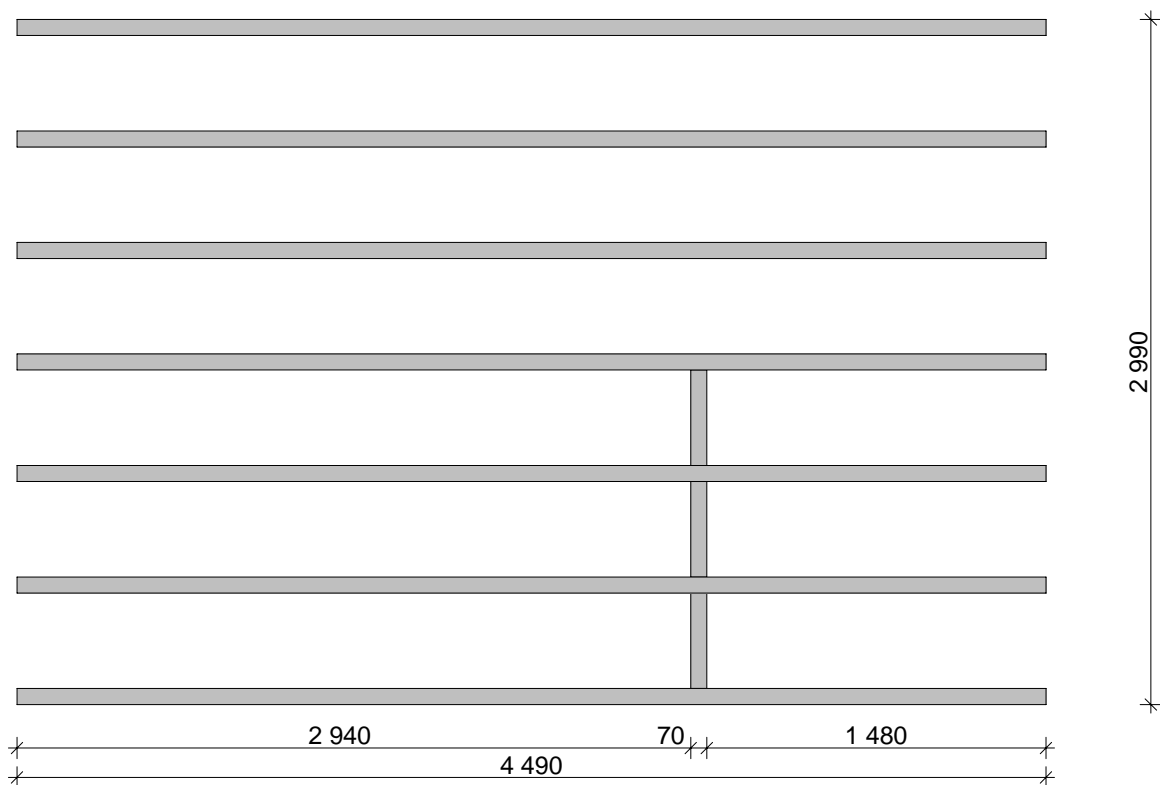

Oriental 5 / 40 mm - 470 x 320 cm

Wall A

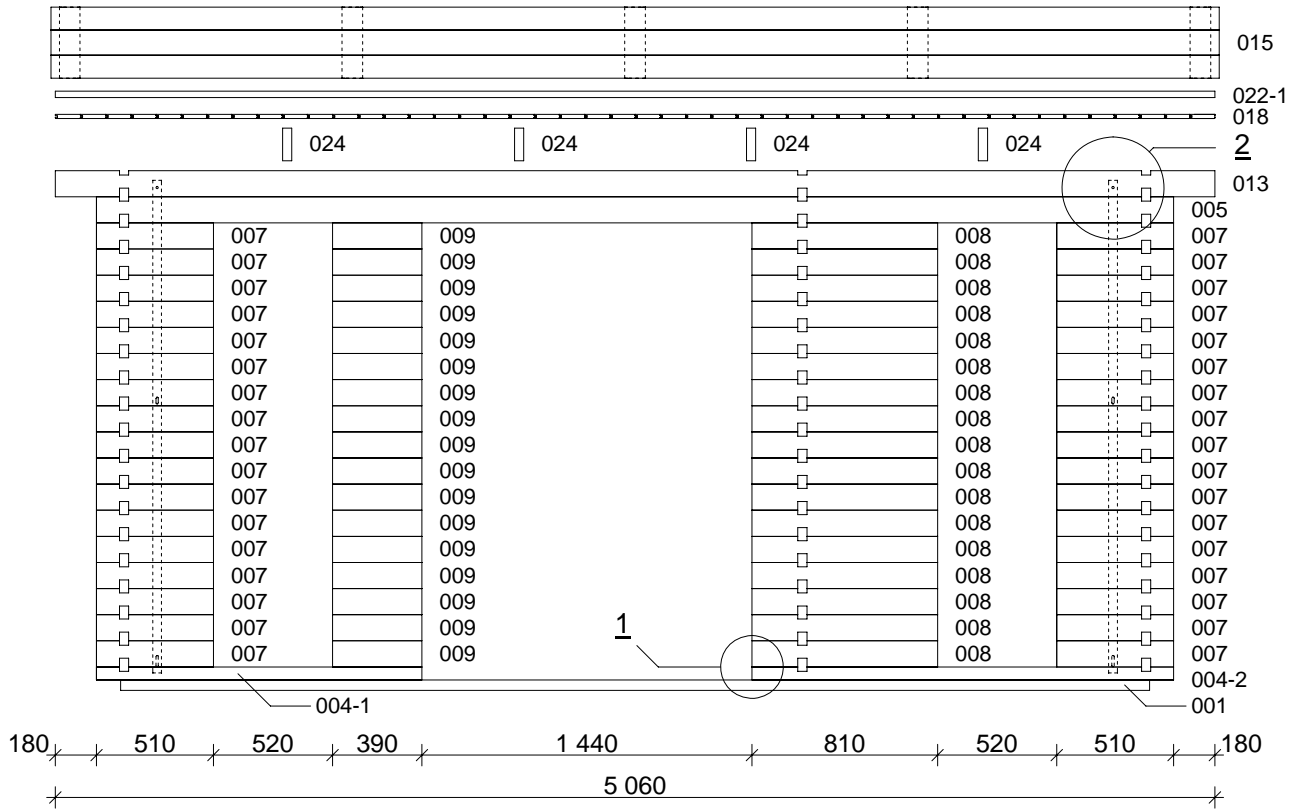

Wall B

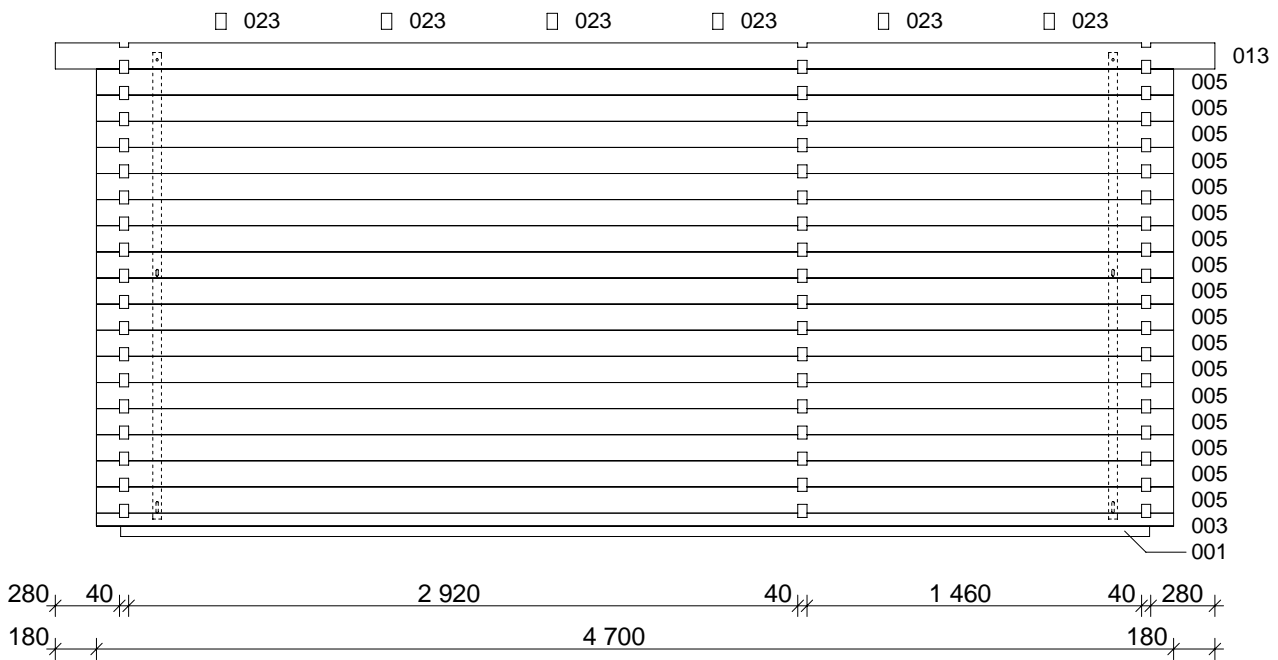

Oriental 5 / 40 mm - 470 x 320 cm

Wall C

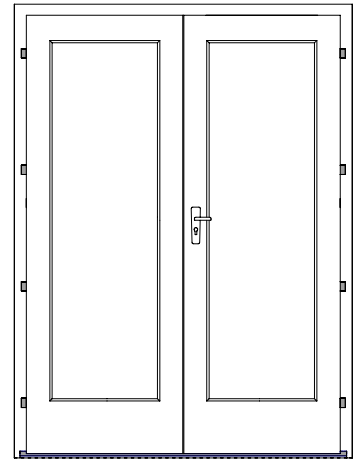
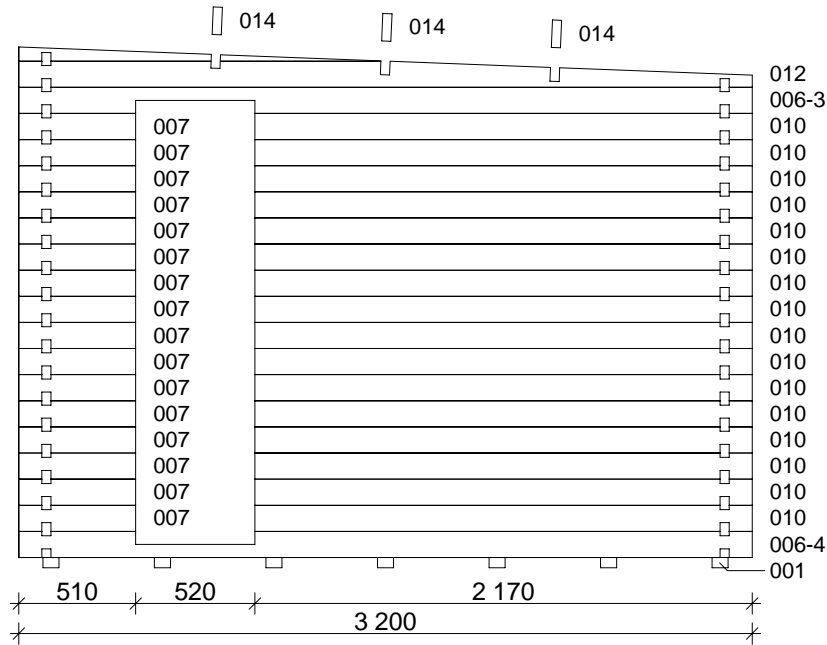

Double door
40 mm / 3mm
1425 x 1955 mm
1 st.

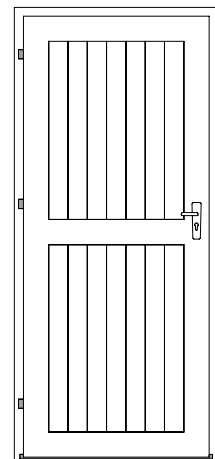

Door
40 mm
840 x 1835 mm
1 st.

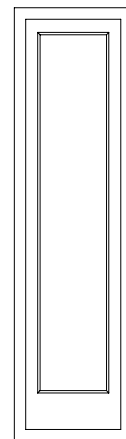

Window
40 mm / 3mm
515 x 1890 mm
3 st.

Wall D

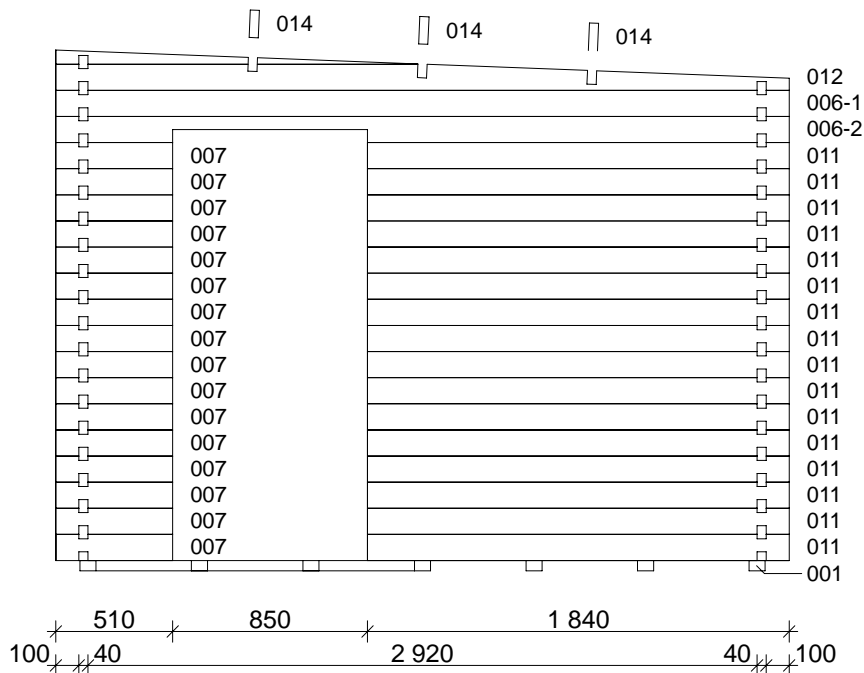

Door
40 mm
840 x 1835 mm
1 st.

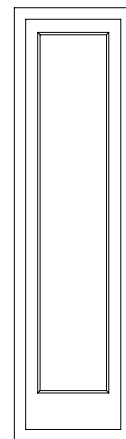

Window
40 mm / 3mm
515 x 1890 mm
3 st.

Oriental 5 / 40 mm - 470 x 320 cm

Wall E

